

# barbas. wood fires

## INSTALLATION INSTRUCTIONS & MANUAL FOR ANNUAL MAINTENANCE

# BOX 45



Barbas wishes you many cosy evenings with your new fire

This document is an essential part of your fire.  
Read it carefully before installation and maintenance  
of the gas fire and keep it in a safe place!



Version number: 04 - 344186

Date: 27-05-2019

Serial number:

Production date:



**barbas bellfires.** fireplaces

fire  
for  
life

**Declaration of Performance**  
According to regulation (EU) 305/2011  
**No. 1.818.081-2 - CPR-2013/07/01**

1. Unique identification code of the product-type	Box 45
2. Intended use or uses of the construction product, in accordance with the applicable harmonised technical specification, as foreseen by the manufacturer	Room heater without hot water supply
3. Name, registered trade name or registered trade mark and contact address of the manufacturer as required pursuant to Article 11(5)	Barbas Bellfires BV; Hallenstraat 17; 5531 AB Bladel; The Netherlands
4. Where applicable, name and contact address of the authorised representative whose mandate covers the tasks specified in Article 12(2)	Not applicable
5. System or systems of assessment and verification of constancy of performance of the construction product as set out in Annex V	System 3
6. In case of the declaration of performance concerning a construction product covered by a harmonised standard	The notified laboratory SGS Nederland BV, No. 0608 performed the determination of the product type on the basis of type testing under system 3 and issued test report EZKA/2016-10/00015-1
7. Declared performance	
<b>Harmonized technical specification</b>	<b>EN13240:2001/A2:2004/AC:2007</b>
<b>Essential characteristics</b>	<b>Performance</b>
<b>Fire safety</b>	<b>Pass</b>
Distance to combustible materials	Minimum distances, in mm Rear = 350 Sides = 300 Ceiling = - Front = 1100 Floor = 30
<b>Risk of burning fuel falling out</b>	Pass
<b>Emission of combustion products</b>	CO = 0.09 vol%
<b>Surface temperature</b>	Pass
<b>Electrical safety</b>	Pass
<b>Cleanability</b>	Pass
<b>Release of dangerous substances</b>	NPD
<b>Maximum operating pressure</b>	Not applicable
<b>Flue gas temperature at nominal heat output</b>	T = 302 °C
<b>Mechanical resistance (to carry a chimney/flue)</b>	NPD
<b>Thermal output</b>	Pass
Nominal heat output	6 kW
Room heating output	6 kW
Water heating output	- kW
<b>Energy efficiency</b>	75.8 %
8. The performance of the product identified in point 1 is in conformity with the declared performance in point 7. This declaration of performance is issued under the sole responsibility of the manufacturer identified in point 3.	

Signed for and on behalf of the manufacturer by:

Danny Baijens, CEO  
(Name and function)

Bladel; September 18, 2018  
(place and date of issue)

  
.....  
(Signature)

# barbas bellfires.



## Declaration of Performance

According to regulation (EU) 305/2011

### No. 1.818.082-2 - CPR-2013/07/01

1. Unique identification code of the product-type	Box 45 with woodlog storage module																																				
2. Intended use or uses of the construction product, in accordance with the applicable harmonised technical specification, as foreseen by the manufacturer	Room heater without hot water supply																																				
3. Name, registered trade name or registered trade mark and contact address of the manufacturer as required pursuant to Article 11(5)	Barbas Bellfires BV; Hallenstraat 17; 5531 AB Bladel; The Netherlands																																				
4. Where applicable, name and contact address of the authorised representative whose mandate covers the tasks specified in Article 12(2)	Not applicable																																				
5. System or systems of assessment and verification of constancy of performance of the construction product as set out in Annex V	System 3																																				
6. In case of the declaration of performance concerning a construction product covered by a harmonised standard	The notified laboratory SGS Nederland BV, No. 0608 performed the determination of the product type on the basis of type testing under system 3 and issued test report EZKA/2016-10/00015-1																																				
7. Declared performance	<table> <tr> <td>Harmonized technical specification</td><td>EN13240:2001/A2:2004/AC:2007</td></tr> <tr> <td>Essential characteristics</td><td>Performance</td></tr> <tr> <td>Fire safety</td><td>Pass</td></tr> <tr> <td>Distance to combustible materials</td><td>Minimum distances, in mm Rear = 350 Sides = 300 Ceiling = - Front = 1100 Floor = -</td></tr> <tr> <td>Risk of burning fuel falling out</td><td>Pass</td></tr> <tr> <td>Emission of combustion products</td><td>CO = 0.09 vol%</td></tr> <tr> <td>Surface temperature</td><td>Pass</td></tr> <tr> <td>Electrical safety</td><td>Pass</td></tr> <tr> <td>Cleanability</td><td>Pass</td></tr> <tr> <td>Release of dangerous substances</td><td>NPD</td></tr> <tr> <td>Maximum operating pressure</td><td>Not applicable</td></tr> <tr> <td>Flue gas temperature at nominal heat output</td><td>T = 302 °C</td></tr> <tr> <td>Mechanical resistance (to carry a chimney/flue)</td><td>NPD</td></tr> <tr> <td>Thermal output</td><td>Pass</td></tr> <tr> <td>Nominal heat output</td><td>6 kW</td></tr> <tr> <td>Room heating output</td><td>6 kW</td></tr> <tr> <td>Water heating output</td><td>- kW</td></tr> <tr> <td>Energy efficiency</td><td>75.8 %</td></tr> </table>	Harmonized technical specification	EN13240:2001/A2:2004/AC:2007	Essential characteristics	Performance	Fire safety	Pass	Distance to combustible materials	Minimum distances, in mm Rear = 350 Sides = 300 Ceiling = - Front = 1100 Floor = -	Risk of burning fuel falling out	Pass	Emission of combustion products	CO = 0.09 vol%	Surface temperature	Pass	Electrical safety	Pass	Cleanability	Pass	Release of dangerous substances	NPD	Maximum operating pressure	Not applicable	Flue gas temperature at nominal heat output	T = 302 °C	Mechanical resistance (to carry a chimney/flue)	NPD	Thermal output	Pass	Nominal heat output	6 kW	Room heating output	6 kW	Water heating output	- kW	Energy efficiency	75.8 %
Harmonized technical specification	EN13240:2001/A2:2004/AC:2007																																				
Essential characteristics	Performance																																				
Fire safety	Pass																																				
Distance to combustible materials	Minimum distances, in mm Rear = 350 Sides = 300 Ceiling = - Front = 1100 Floor = -																																				
Risk of burning fuel falling out	Pass																																				
Emission of combustion products	CO = 0.09 vol%																																				
Surface temperature	Pass																																				
Electrical safety	Pass																																				
Cleanability	Pass																																				
Release of dangerous substances	NPD																																				
Maximum operating pressure	Not applicable																																				
Flue gas temperature at nominal heat output	T = 302 °C																																				
Mechanical resistance (to carry a chimney/flue)	NPD																																				
Thermal output	Pass																																				
Nominal heat output	6 kW																																				
Room heating output	6 kW																																				
Water heating output	- kW																																				
Energy efficiency	75.8 %																																				
8. The performance of the product identified in point 1 is in conformity with the declared performance in point 7. This declaration of performance is issued under the sole responsibility of the manufacturer identified in point 3.																																					

Signed for and on behalf of the manufacturer by:

Danny Baijens, CEO  
(Name and function)

Bladel; September 18, 2018  
(place and date of issue)

(Signature)

## TABLE OF CONTENTS

	Page
1 Introduction	
1.1 General .....	7
1.2 Safety and installation instructions .....	8
2 Placing	
2.1 Included .....	10
2.2 Preparation for positioning .....	10
2.3 Accessories .....	11
3 Installation	
3.1 Instructions .....	13
3.2 Flue gas channel .....	13
3.3 Fitting .....	14
3.4 Preparation / Function check .....	16
4 Operation .....	18
5 Annual maintenance .....	20
6 Replacement parts .....	22
7 Dimensions .....	27
8 Technical data .....	29
9 Warranty terms .....	30



## 1 INTRODUCTION

### 1.1 GENERAL

The appliance must be positioned and connected by a Barbas dealer/specialist in accordance with the following installation instructions, nationally and locally applicable regulations. This manual contains directions for both positioning the appliance and for its environmentally-friendly use. It also contains technical data for the appliance, parts information and directions in the event of problems.

This appliance is recommended as suitable for use in smoke control areas when burning wood logs. The appliance, when sold into the UK market, include a factory-installed modified air slider to ensure compliance with smoke emission requirements within smoke control areas.

Study this manual carefully before using the fireplace. We recommend you keep this manual in a safe place for reference purposes.

The pictures in this Installation Instructions are made from a variant of this appliance. Although the dimensions of the appliance on the pictures may differ from reality, the actions and instructions shown are fully valid for the appliance described here.

See the “Instructions for use” for the operation of the appliance

The “Instructions for use” is provided separately by the appliance.

#### “The Clean Air Act 1993 and Smoke Control Areas”

Under the Clean Air Act local authorities may declare the whole or part of the district of the authority to be a smoke control area. It is an offence to emit smoke from a chimney of a building, from a furnace or from any fixed boiler if located in a designated smoke control area. It is also an offence to acquire an “unauthorised fuel” for use within a smoke control area unless it is used in an “exempt” appliance (“exempted” from the controls which generally apply in the smoke control area).

In England appliances are exempted by publication on a list by the Secretary of State in accordance with changes made to sections 20 and 21 of the Clean Air Act 1993 by section 15 of the Deregulation Act 2015.

In Scotland appliances are exempted by publication on a list by Scottish Ministers under section 50 of the Regulatory Reform (Scotland) Act 2014.

In Northern Ireland appliances are exempted by publication on a list by the Department of Agriculture, Environment and Rural Affairs under Section 16 of the Environmental Better regulation Act (Northern Ireland) 2016.

In Wales appliances are exempted by regulations made by Welsh Ministers.

Further information on the requirements of the Clean Air Act can be found here:

<https://www.gov.uk/smoke-control-area-rules>.

Your local authority is responsible for implementing the Clean Air Act 1993 including designation and supervision of smoke control areas and you can contact them for details of Clean Air Act requirements.

## 1.2 SAFETY AND INSTALLATION INSTRUCTIONS

- Do not place flammable objects within 110 cm of the radiation area of the appliance. Pay special attention to furnishings and ornaments around the appliance.
- To ensure safe operation, the following minimum distances must be maintained between the appliance and any combustible material at the side, rear and top of the appliance (temperature  $\leq 80^{\circ}\text{C}$ ).  
in respect of side wall: Distance minimal 30 cm  
in respect of rear wall: Distance minimal 35 cm  
in respect of top: Distance minimal 50 cm.
- The minimum distance between the side, rear and top of the appliance and a wall of non-combustible material must be at least 5 cm.
- When placed on a combustible floor, a hearth of non-combustible material must be placed underneath the appliance. This hearth shall extend at least 20 cm on each side of the appliance. If the appliance is placed without the optional wood log storage module, the hearth shall have a minimum thickness of 3 cm.
- When you use your appliance, the exterior will become hot. Always wear the glove or use the accessories supplied when filling etc.  
Protect yourself and others (especially children!) from burns. Do not leave children unattended when the appliance is burning.
- Watch your clothing. Synthetic clothing in particular can easily catch fire and burn intensely.
- Do not approach the appliance with flammable materials or liquids. Any work with solvents, adhesives etc. in the space heated by the appliance can be very dangerous.
- It is not allowed to connect the appliance to a flue which is already connected to another appliance.
- Check the chimney. Cracks in the chimney may not only lead to damp, staining of walls and leaking of smoke, they can also impair the carrying off of smoke.
- Prevent your chimney being soiled from above (birds' nests etc.) by fitting a suitable cap to the chimney pot.
- The appliance must be placed on a sufficient solid floor that can bear the weight of the appliance. (see chapter 8 "Technical data").
- Avoid chimney fires! Have your chimney swept at least once per year - more often if you use your fire a lot. Prevent excessive deposits of soot inside the chimney by not burning freshly-cut wood. Instead, burn clean, dry chopped wood.



- Follow the instructions issued by your local fire brigade.  
The appliance can be taken in operation if national and local regulations are satisfied.  
The required constructive adaptations should be satisfied as well.
- It is essential that the appliance, the flue and combustion air supply are cleaned and inspected annually by a Barbas dealer/specialist.  
The safe operation of the appliance will thus remain guaranteed.
- The appliance is suitable and approved for periodical use.
- The appliance may only be set up if the appliance and location meets the
  - national and local installation regulations;
  - local fire brigade regulations and required architectural provisions.
- Ensure that the room in which the appliance is situated has adequate ventilation.
- Wood and wood briquettes may be stoked in the appliance.  
Do not use any coal and liquid fuels or fuel gel in the appliance. The appliance is not intended for use of this fuels and can be dangerous and lead to damage to your health and may seriously damage the appliance.
- **Never** use the appliance to burn rubbish.
- Please read all instructions / stickers on and around the appliance.
- Read the “Directions for use” before using the appliance for the first time. When you first fire up your appliance, there are a number of extra points you should take into account.
- In transit, some parts of the appliance may have moved from their original place. Check that the door opens and closes, the baffle plates are fitted correctly to the brackets at the top of the appliance and the heat-resistant panels are fixed to the walls. Check if there are no foreign objects in the appliance.
- Avoid over-loading (white burning glow), caused, for example, by lengthy burning with primary air (combustion air supply slider all the way to “+”) or by burning too much wood in one go. The appliance can then become over-heated.
- Ask for the local building regulations, before commencing the installation of the appliance.

## 2 LOCATION

### 2.1 INCLUDED

Set documentation	<ul style="list-style-type: none"><li>• Directions for use</li><li>• Installation instructions</li></ul>
Attributes	<ul style="list-style-type: none"><li>• Glove (Heat resistant up to max. 95°C)</li><li>• Operating hook / Poker</li></ul>

N.B. If any part is missing, please contact your dealer.

### 2.2 ACCESSORIES

The following accessories can be supplied by your dealer:

Thick-walled (2 mm) steel chimney system Ø130 mm:

<u>Part no</u>	<u>Description</u>
343123	Pipe 1950 mm with reduction
343117	Pipe 500 mm with reduction
343116	Pipe 1000 mm with reduction
343120	Elbow 90°
343119	Elbow 45°
343118	Elbow 30°
343015	Support sleeve (L= 190 mm) double-walled
343016	Rosette

## 2.3 PREPARATION FOR POSITIONING

Check all functions of the appliance before fitting.

- Check the opening and closing operation of the door.

Turn the handle all the way down:

Door is locked.

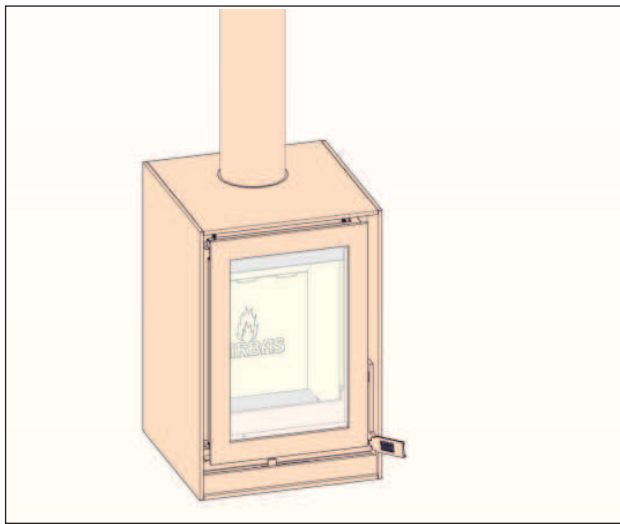

Handle forwards:

The door releases from its lock and can be opened forwards.

For this, use the operating hook supplied.

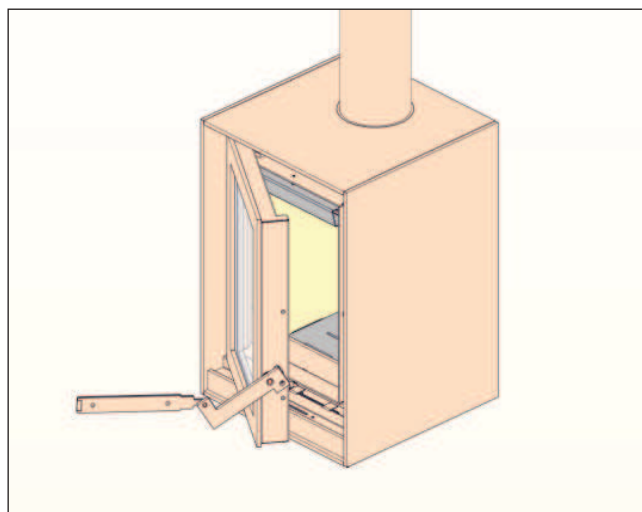
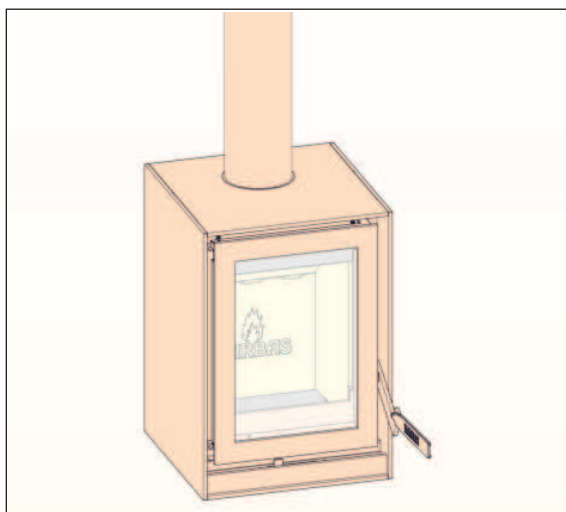

- Check whether the 2 baffle plates are located correctly in the supports.
- Check the operation of the slider for the regulation of the combustion air intake (middle below the window).

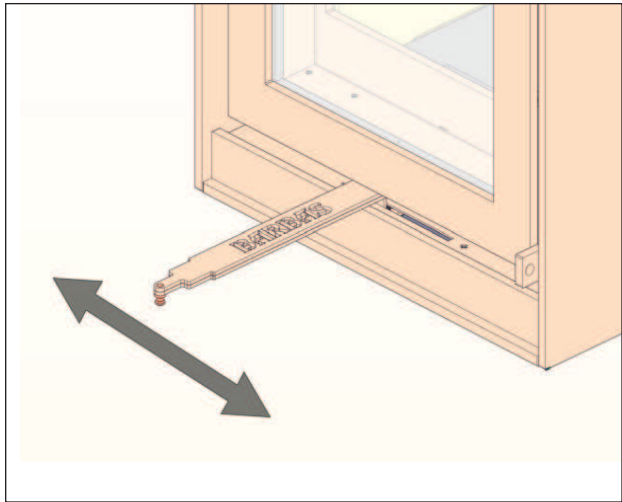
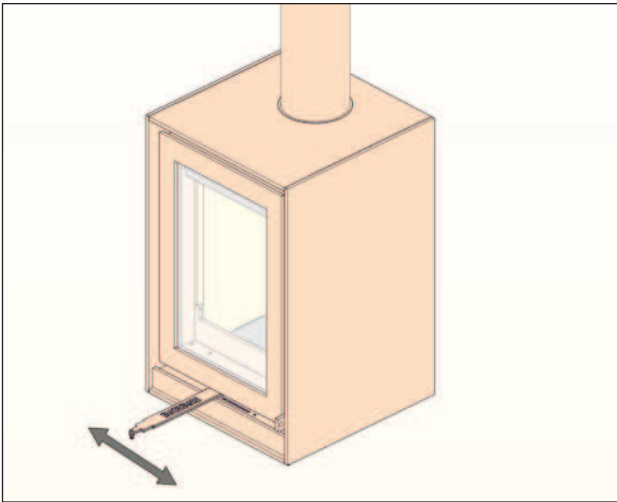

- Check whether the ashtray is completely empty.

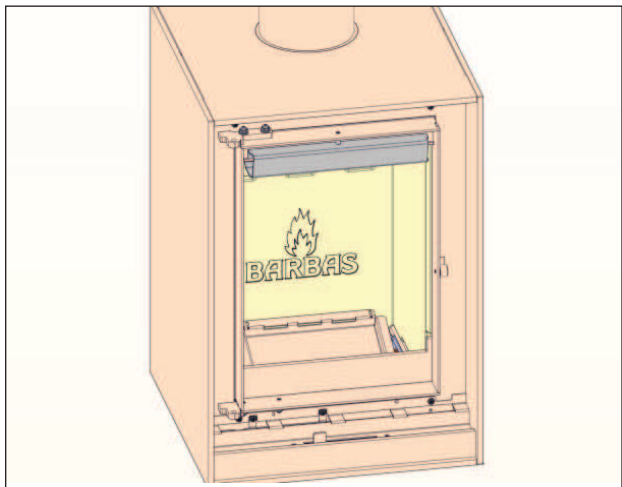
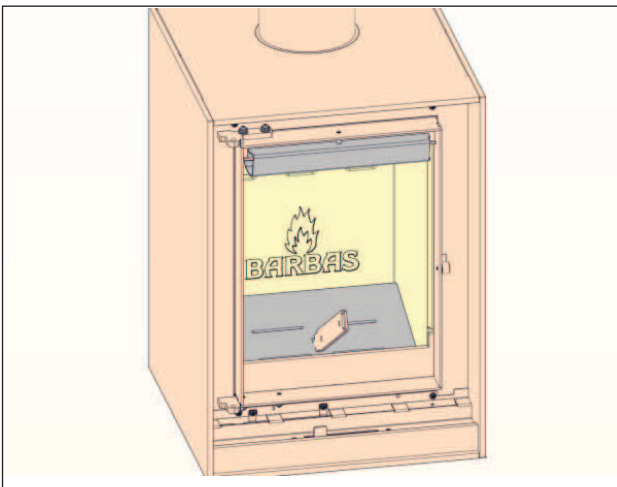

- Report any defects immediately to your dealer.
- Remove enclosed documents and components from the appliance.
- Have the suitability of the area in which the appliance is to be placed (and the chimney) approved by a specialist. The stove must have its own chimney, constructed in compliance with current legislation.

### 3 INSTALLATION INSTRUCTIONS

#### 3.1 FITTING INSTRUCTIONS

When fitting the stove, local and/or national regulations relating to fire safety must be followed. In case of doubt, consult the fire safety department of the local fire brigade, particularly if the stove is to be fitted in a home with walls and/or floors containing flammable material.

Position the appliance sufficiently far away from the wall behind it, according to the data from chapter 1.2. If the walls are not fire-proof, the distance should be such that the wall in question cannot become hotter than 80°C, even when the stove is stoked up to high temperatures. In case of doubt, insert a fire-proof protection shield.

The floor on which the appliance is placed must have sufficient bearing power.

The connection of several appliances to a single flue/chimney is not allowed.

#### 3.2 CHIMNEY

Be sure that existing chimneys are completely air-tight and in good condition. In terms of dimensions, the chimney must have a diameter of at least 130 mm for the entire length (including the chimney pot).

Ensure that the chimney is fitted with an appropriate cap to avoid rain and dirt getting in (as well as bird's nests).

The draught flowing through the chimney determines how well your stove will burn (minimum draught 0.12 mbar = 12 Pa; recommended draught 0.15 mbar = 15 Pa).

In the event of problems, a solution may be a different chimney cap, if necessary one with a chimney fan. Contact a specialist if you have any doubts about any of the above points.

If your chimney is unsuitable, or if your home does not have a chimney, we recommend the use of double-walled stainless steel chimney sections. Chimneys must comply with the prevailing building regulations. Make sure the building is carried out by a specialist. When purchasing such chimneys, be sure to check if a casing is required.

##### Important:

- Chimneys must be free-standing, i.e. they must not rest on the appliance itself.
- Any pipe connections that are not insulated must also be fully insulated.
- Flammable material must be kept clear (outside the casing/insulation zone) of all through-feeds in the floor or wall (remember the roof decking).
- The chimney opening must be at least 5 metres above the top of the door opening of your appliance.
- The chimney must protrude at least 40 cm above the apex of a sloping roof and at least 1 metre above a flat roof. In short, the chimney must always end in an area with a negative air pressure. Contact your local chimney sweep for the exact dimensions of the chimney opening.

Between the stove and chimney, use thick-walled smoke piping (Steel,  $\geq 2$  mm). See Chapter 2.2.

The first pipe connected to the appliance must have a diameter of 130 mm at both ends. This will prevent any condensation from the chimney running over the external end of the pipe. Connect the pipes to the existing chimney (ceiling) using a sliding sleeve (niche pipe). Check all connections for air-tightness.

If there is too much draught running through your chimney (e.g. if the chimney is long and straight in a tall building), it may be possible to insert a chimney valve in the pipe near the appliance. Before doing this, be sure to obtain sound advice from a specialist.

Do not make any horizontal connections. Deposits and soot will accumulate here (unless it is a short horizontal connection directly behind the stove).  
Avoid bends at all costs. The maximum deviation from the perpendicular is  $45^\circ$ .

The chimney calculation, as in Germany, is made according to DIN 4705 parts 1 and 2.

#### The mass flow and exhaust temperature of the stove

The mass flow and exhaust temperature of the stove are shown in chapter 8; Technical Data. These values are important to consider when assessing the dimensions of the flue to which the stove is to be connected.

#### Cleaning the chimney/flue

Make sure your chimney/flue is cleaned at least once a year by a recognized chimney sweep.

If the chimney has a chimney valve, the free opening in the chimney valve flap must measure at least 12% of the surface.

### **3.3 COMBUSTION AIR**

Combustion air is needed to keep the combustion going by drawing in air from the room, or directly from outside, due to the natural draught of the chimney.

On delivery, the appliance is prepared for a combustion air supply from the living room or a combustion air supply directly from the outside, through the underside or through the back of the appliance.

- Combustion air from the living-room:

The air inlet openings are located under the operating flap. When using the appliance, please ensure there is a sufficient supply of fresh air: use a grate with a minimum net opening in the outer wall of  $50 \text{ cm}^2$ .

Make sure that the ventilation supply is open; this is particularly important with today's airtight dwellings.

If the dwelling has mechanical ventilation that creates under pressure in the room where the appliance is located, it is necessary to fit a flue gas fan.

The type of flue gas fan is dependent on the capacity of the mechanical ventilation system. Always consult your fitter about this.

In dwellings with an operating extractor hood, this should be turned to the lowest setting or turned off altogether. If the extractor hood remains in use, additional ventilation must be provided in compensation. This will not only avoid poor combustion, but will also prevent flue gases being sucked from the appliance into the room.

Should creating an extra ventilation opening prove insufficient, it is then necessary to fit a flue gas fan.

- Combustion air directly from outside:

The appliance now has a completely closed combustion system, which allows it to operate independently of the surrounding air in the room where the appliance is located.

The combustion air supply can be connected to the back or the underside of the appliance. To do this, use combustion air connection Ø80 mm (exterior) for the back or underside. Install a fixed or flexible pipe of Ø80 mm in the wall/floor between this air supply connection and outside air supply inlet. We recommend that this pipe is fitted with a sealing valve in order to prevent condensation in the appliance when it is not in use.

### 3.4 FITTING THE STOVE

#### 3.4.1 Positioning

The appliance can make use of either a top or rear connection Ø130 mm for the flue (chimney).

This connection is intended for steel stovepipes, double/single-skinned stainless steel (insulated) flues or double/single-skinned flexible stainless steel flues.

Situate the appliance in such a way that the flue gas outlet is precisely in line under the chimney connection (niche pipe) in the ceiling (top connection) or with the chimney connection (niche pipe) in the wall (rear connection).

Level off the appliance using the adjustable feet (not for Box with wood log storage module!). The adjustable feet are accessible from the combustion chamber. To do this remove the steel sheets on both sides of the grate. Using an Allen key no. 4 to set the adjustable feet on the correct height.

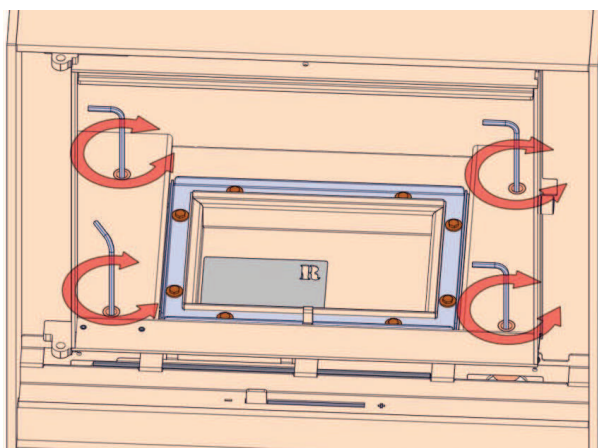

If the appliance is placed on a natural stone platform, the following must be considered:

- Place the appliance approximately 3 mm above the platform by means of the adjustable feet.
- The platform must have minimum thickness of 3 cm.
- The platform must support the weight of the appliance directly underneath it.
- Ask your natural stone dealer for additional advice regarding the specific type of stone in combination with the appliance.

When placed on a surface of combustible material, an insulating plate of at least 3 cm thickness between the appliance and the combustible material must be placed.



### 3.4.2 Connecting to the chimney

#### Ceiling connection:

Insert a pipe into the sliding sleeve (niche pipe) to the ceiling as deep as possible. Position a chimney pipe on the top plate and mark off where the top pipe should be shortened.

Shorten the top pipe and insert it, once more, as deep as possible into the sliding sleeve in the ceiling. Position the lower pipe over the sealing washer. Now pull the top pipe down and over the bottom pipe.

#### Wall connection:

Determine the length of pipe required and push this as far as possible into the sliding sleeve before the appliance is placed.

Once the appliance is placed, you can pull the pipe from the sliding sleeve and slide it over the connection ring on the appliance.



Any seams in the flue gas outlet (pipes) joints should be sealed with a heat-resistant kit that remains elastic or with a glass-fibre cord.

## 4 OPERATION

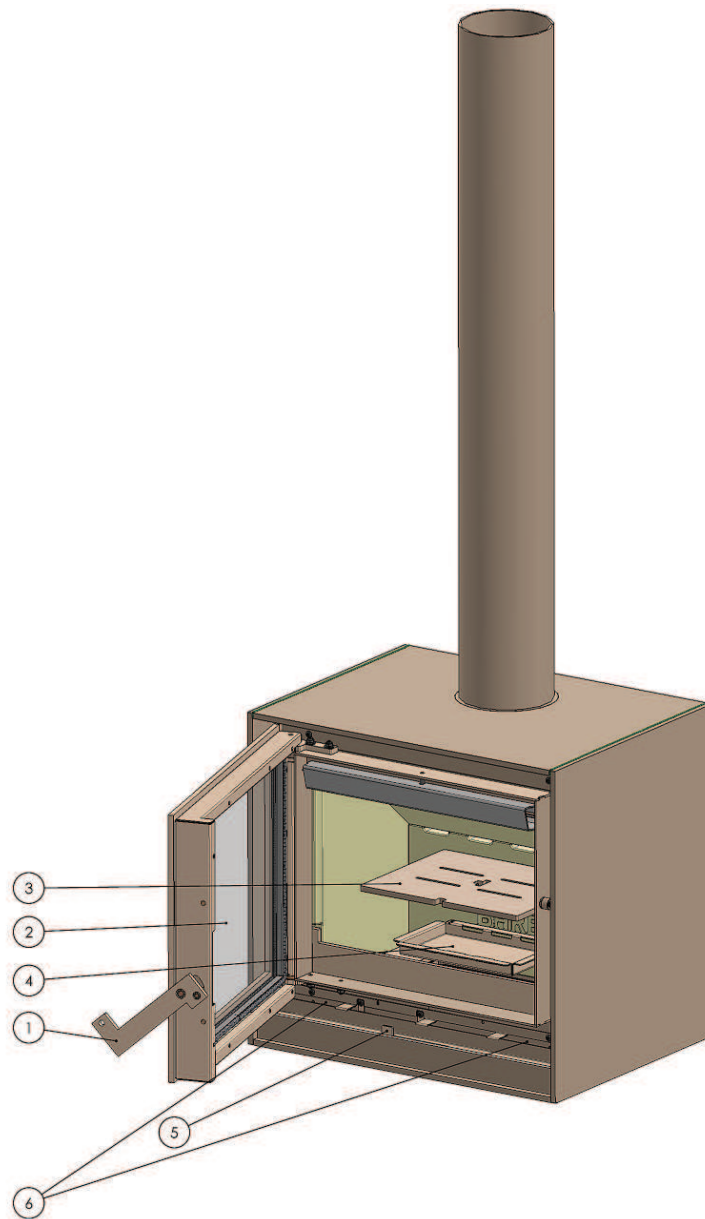

**Figure 1: Operation Box**

- 1 Handle
- 2 Ceramic heat-proof glass
- 3 Grate
- 4 Ashtray
- 5 Combustion air-supply slider (Combined operation for the primary, secondary and tertiary combustion air-supply)
- 6 Inlet opening (2x) combustion air from living-room, if a direct outside air supply is not connected. This will be determined when the appliance is installed.  
Do not EVER close open inlet openings.
- 7 External connection combustion air supply (not pictured: possible at the bottom)

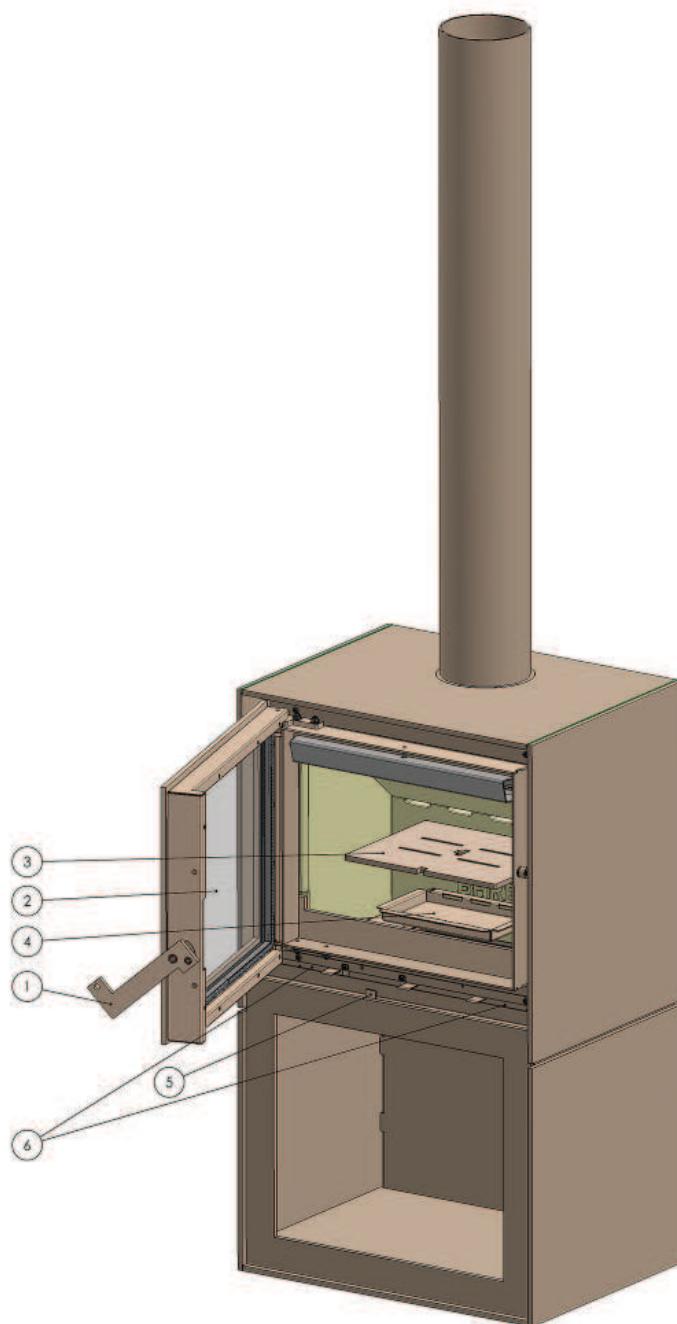

**Figure 2: Operation Box with wood log store module**

- 1 Handle
- 2 Ceramic heat-proof glass
- 3 Grate
- 4 Ashtray
- 5 Combustion air-supply slider (Combined operation for the primary, secondary and tertiary combustion air-supply)
- 6 Inlet opening (2x) combustion air from living-room, if a direct outside air supply is not connected. This will be determined when the appliance is installed.  
Do not EVER close open inlet openings.
- 7 External connection combustion air supply (not pictured: possible at the bottom)

## 5 ANNUAL MAINTENANCE



It is essential that the appliance, the chimney and the combustion air supply are cleaned and inspected annually, by a Barbas-dealer/expert. The safe operation of the appliance will thus remain guaranteed.

Start with maintenance 24 hours after the last burning period.

Recommended order for yearly maintenance:

① Inside the appliance:

- Check the door seals. If necessary, replace the seals.
- Temporarily remove the door, by opening it completely and lifting it upwards.
- Remove the complete interior of the appliance and carefully clean all parts with a hand brush.  
Emptying the ashtray.
- Clean the glass on the inside of the door with glass spray or ceramic hob cleaner.
- If the glass is broken or cracked, it must be immediately replaced before operating the appliance again.



*Broken ceramic heat-resistant glass may not be thrown away in a glass container, but must be included in normal household waste.*

- Check the grate and all interior plates on cracks.  
If necessary, replace the parts.

② Chimney/flue channel:

- Sweep and inspect chimney. Check for cracks, loose parts, flue gas leakage and overall condition of the chimney.  
When in doubt use an inspection camera !

③ Combustion air supply appliance:

- Check the combustion air supply route from the outside up to the appliance.
- Clean the combustion air supply inlet openings.

④ Outside appliance:

- Clean the outside of the appliance with a dry lint free cloth.
- Wait for the appliance to cool down sufficiently before cleaning. Never use scouring powder, aggressive cleaners or fire polish on the appliance.
- Any lacquer damage can be repaired with a BARBAS heat resistant paint spray can. (Pay attention that the appliance is sufficiently cooled down !)

⑤ Ventilation house:

- Check whether the room where the appliance is installed is sufficiently ventilated according to national and local regulations and standards.
- Ensure that as little dust, and as few particles of cigarette smoke, candles and oil lamps as possible pollute the air in the room in which the appliance is used. Heating of these particles by the burning of the appliance could lead to discoloration of the walls and ceiling. It is therefore very important to ensure that the room in which the appliance is located is sufficiently ventilated.

⑥ Last check appliance:

- In reversed order, place back all parts in the appliance.
- Place back the door on the appliance.
- Check the correct operation from the sliders and flaps. See Chapter 2.3: Preparation / Function check.

⑦ General:

- Parts:  
Individual parts for replacement/accessories are available from your BARBAS dealer. Use only original parts.
- Modifications:  
Introduced modifications to the appliance are not permitted.

## 6 REPLACEMENT PARTS

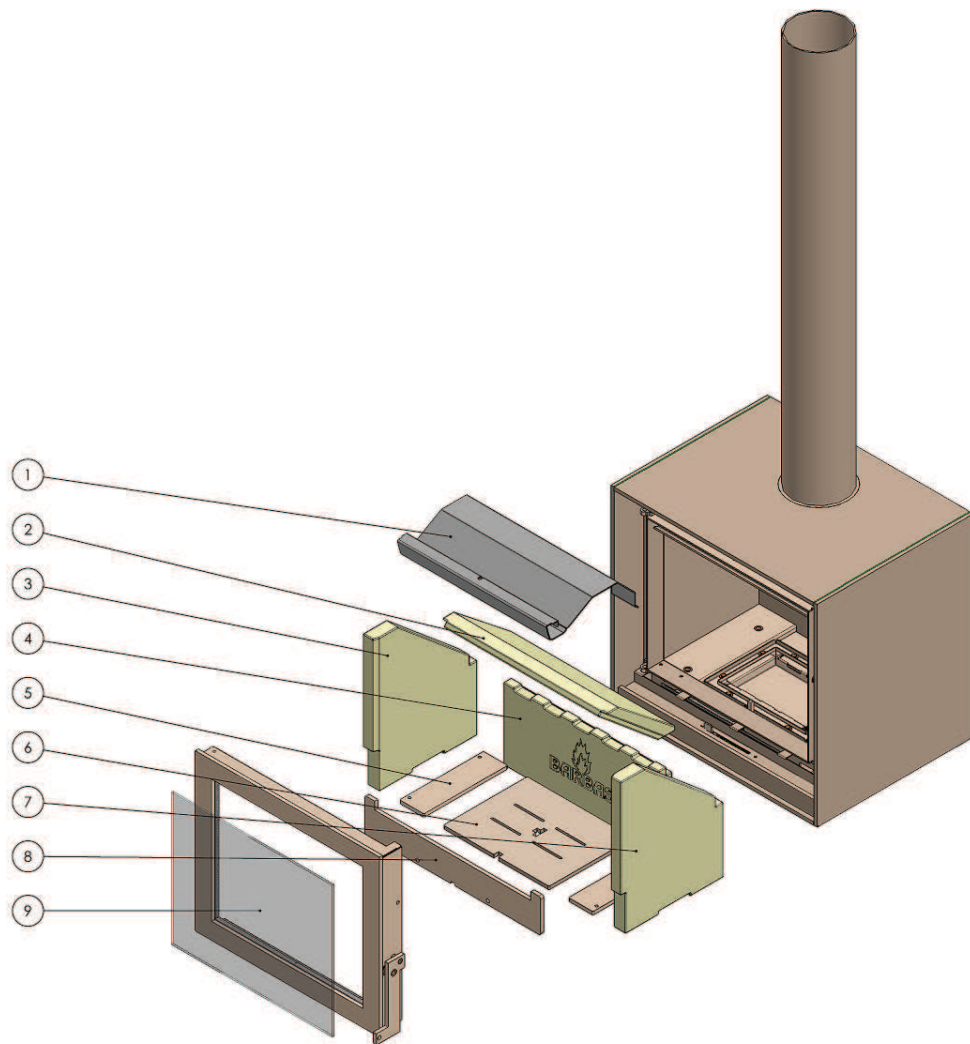

Pos nr.	Article no	Description
1	340637	Baffle plate stainless steel
2	339977	Stone baffle plate
3	340264	Stone side left
4	343281	Stone rear
5	340377	Combustion grate
6	340263	Stone side right
7	340634	Wood rack
8	344169	Ceramic glass

When ordering, please give the serial number.

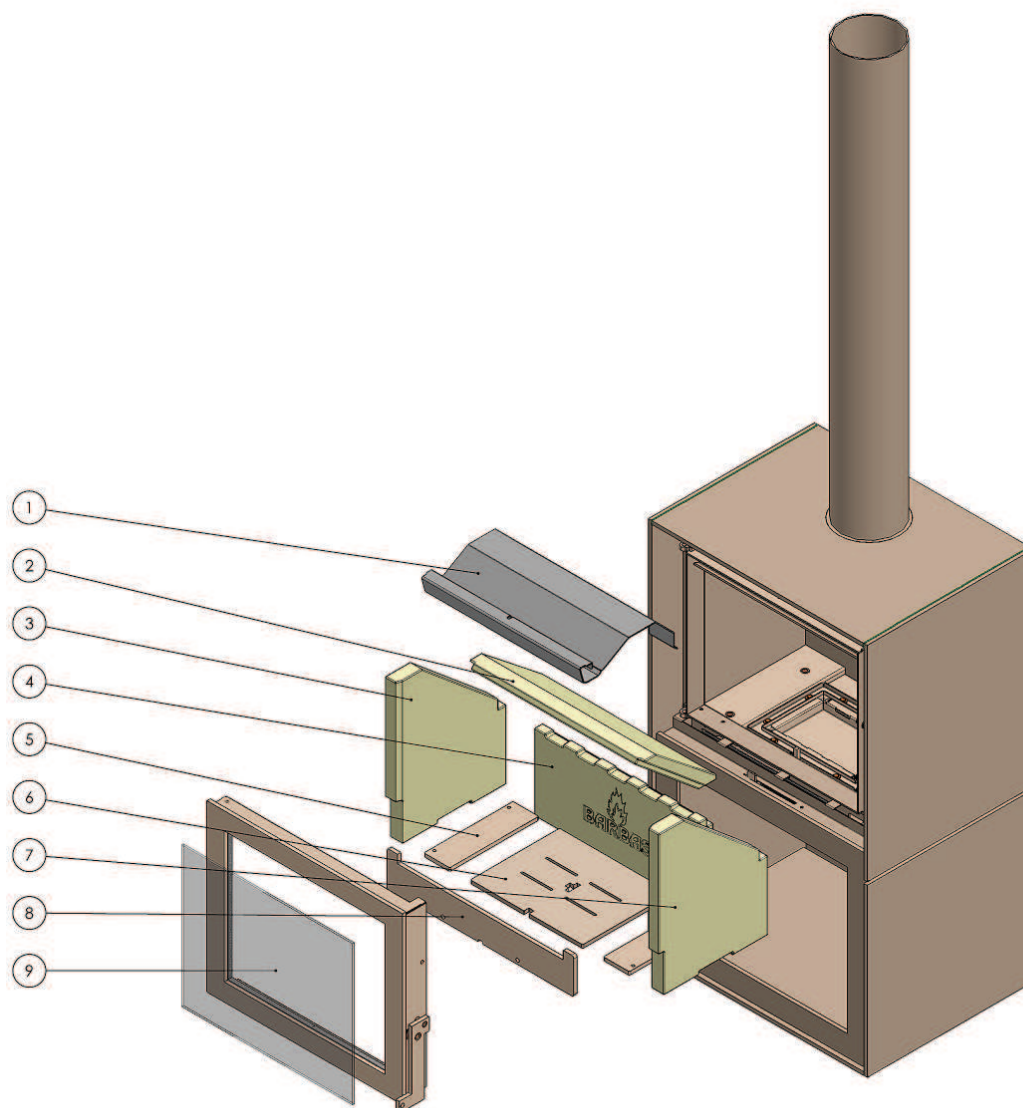

Pos nr.	Article no	Description
1	340637	Baffle plate stainless steel
2	339977	Stone baffle plate
3	340264	Stone side left
4	343281	Stone rear
5	340377	Combustion grate
6	340263	Stone side right
7	340634	Wood rack
8	344169	Ceramic glass

When ordering, please give the serial number.

## 6.1 SEQUENCE FOR REPLACING THE INTERIOR OF THE APPLIANCE

- Remove the grate and the ashtray.

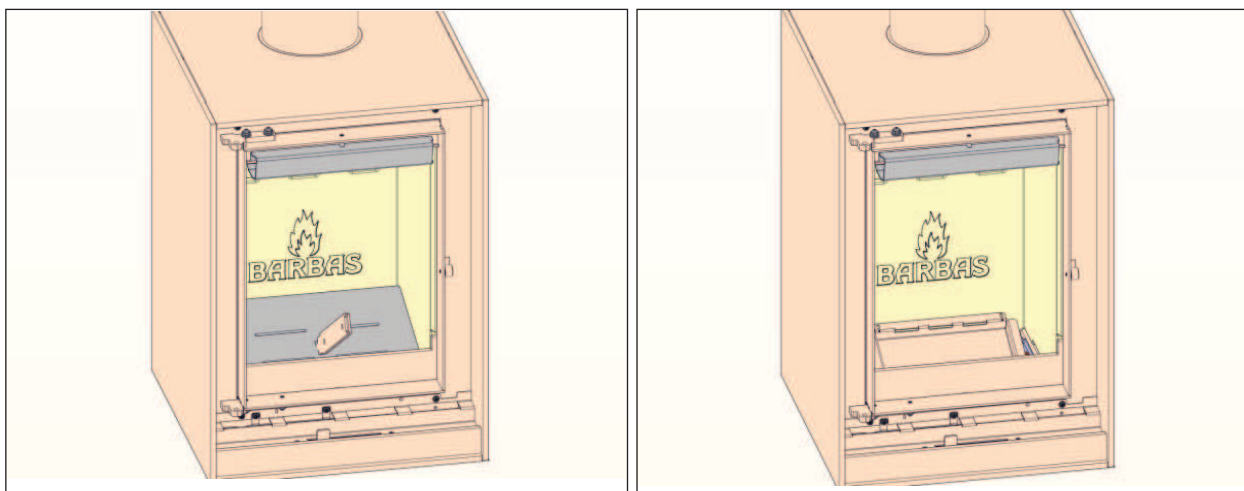

Although the heat resistant panels have been manufactured with the greatest care, there is the possibility that some sharp parts may stick out, possibly causing injuries. We therefore urgently recommend wearing safety gloves when handling the panels.

- Unscrew the locking pin with the aid of an Allen key and a wrench. You can now remove the top baffle plate by pulling it forward slightly and then tipping it downwards. The baffle plate can now be pulled forwards and out.

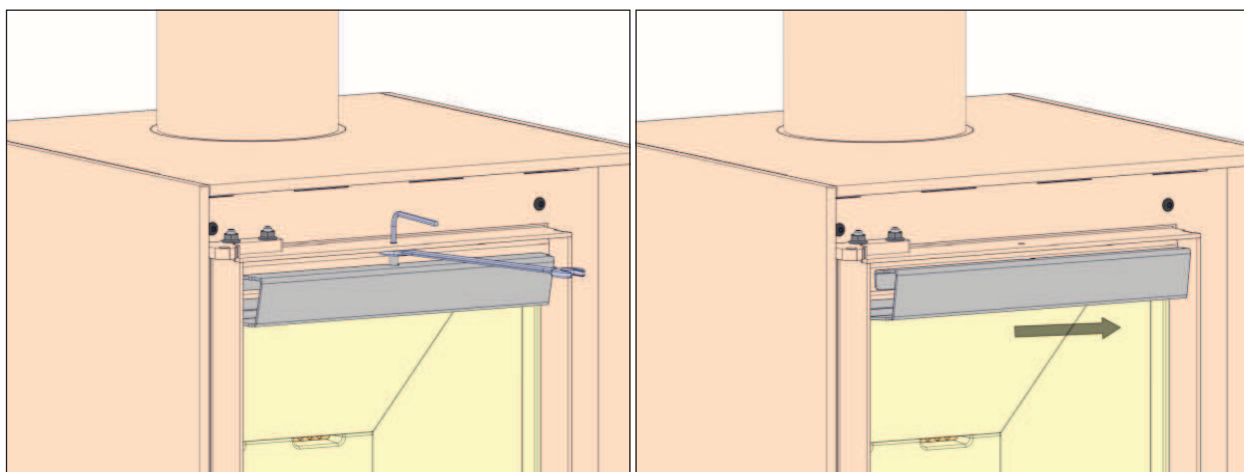



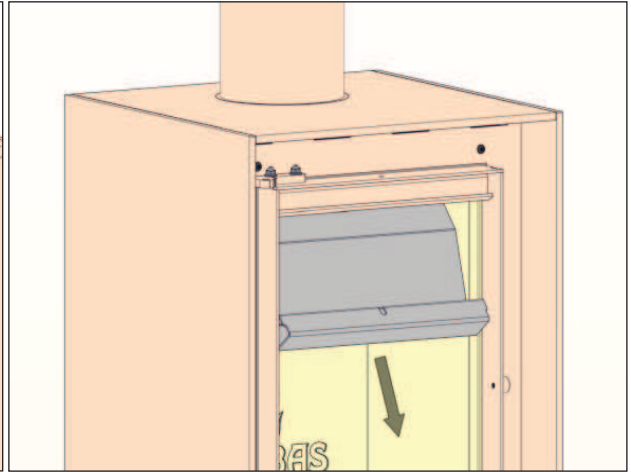
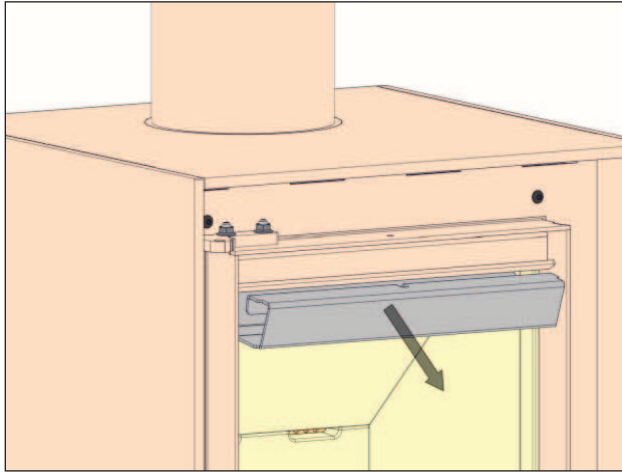

- Remove the bottom baffle plate by lifting it slightly and removing it sloping to one side.

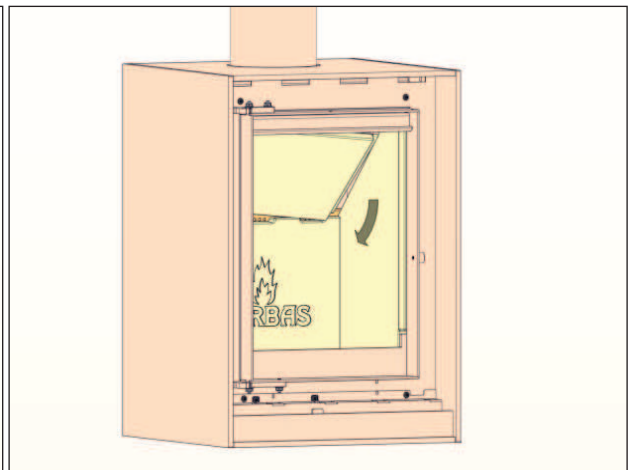
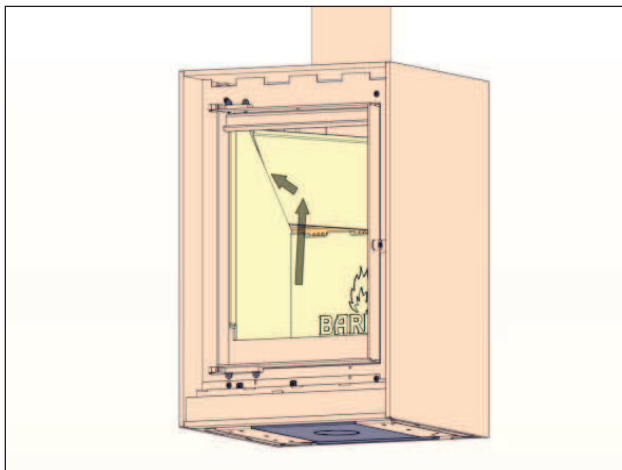

- Remove carefully the rear panel, by lifting it upwards and remove it diagonally forward.

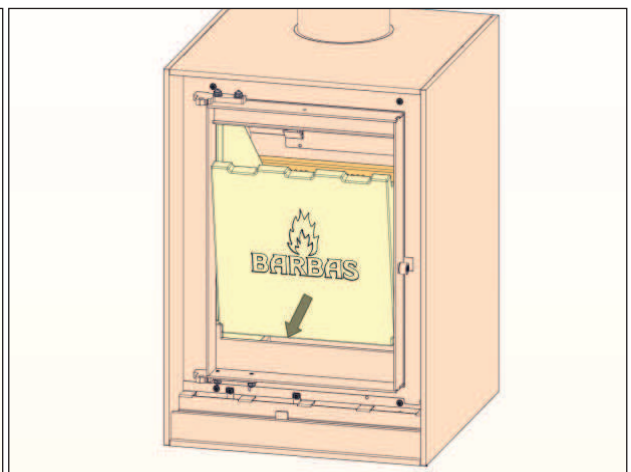
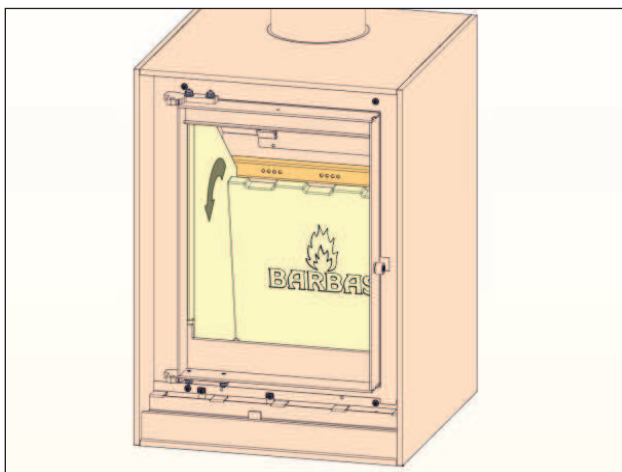

- Remove carefully the left-hand side panel.

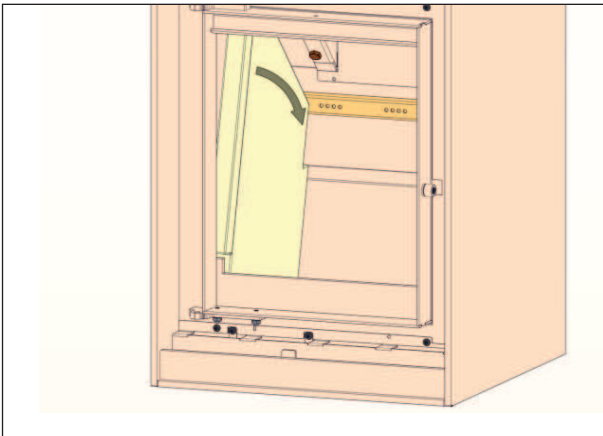

- Remove carefully the right-hand side panel.  
Make sure the rear panels do not fall forwards !

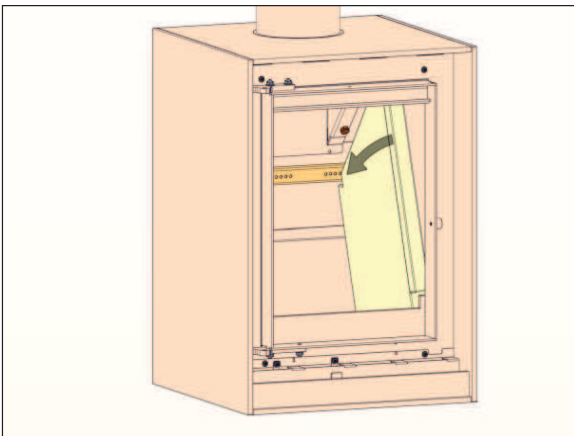

- Finally, remove the wood rack.

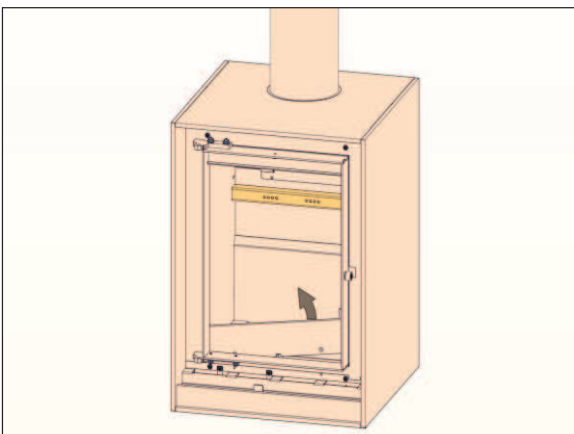

The entire interior is now disassembled.

The interior is reassembled in the reverse order.  
Make sure, when reassembling the interior to start with the wood rack.

## 7 DIMENSIONS

### 7.1 BOX 45

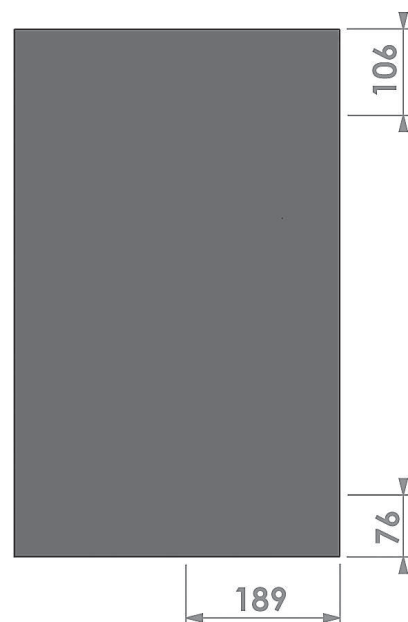
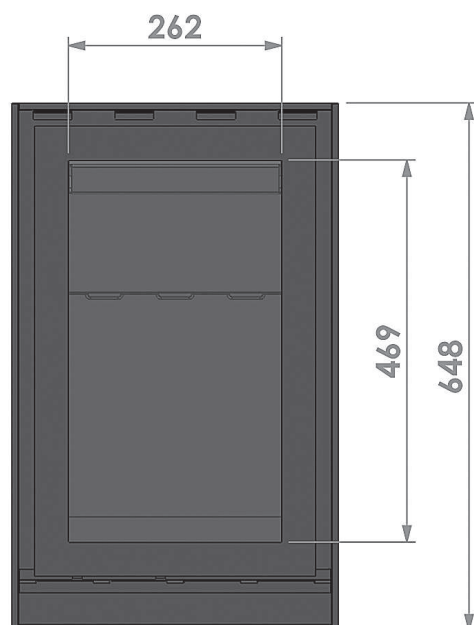
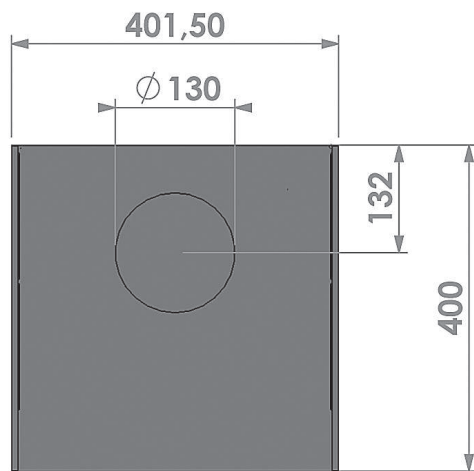

7.2 BOX 45 WITH WOOD LOG STORAGE MODULE

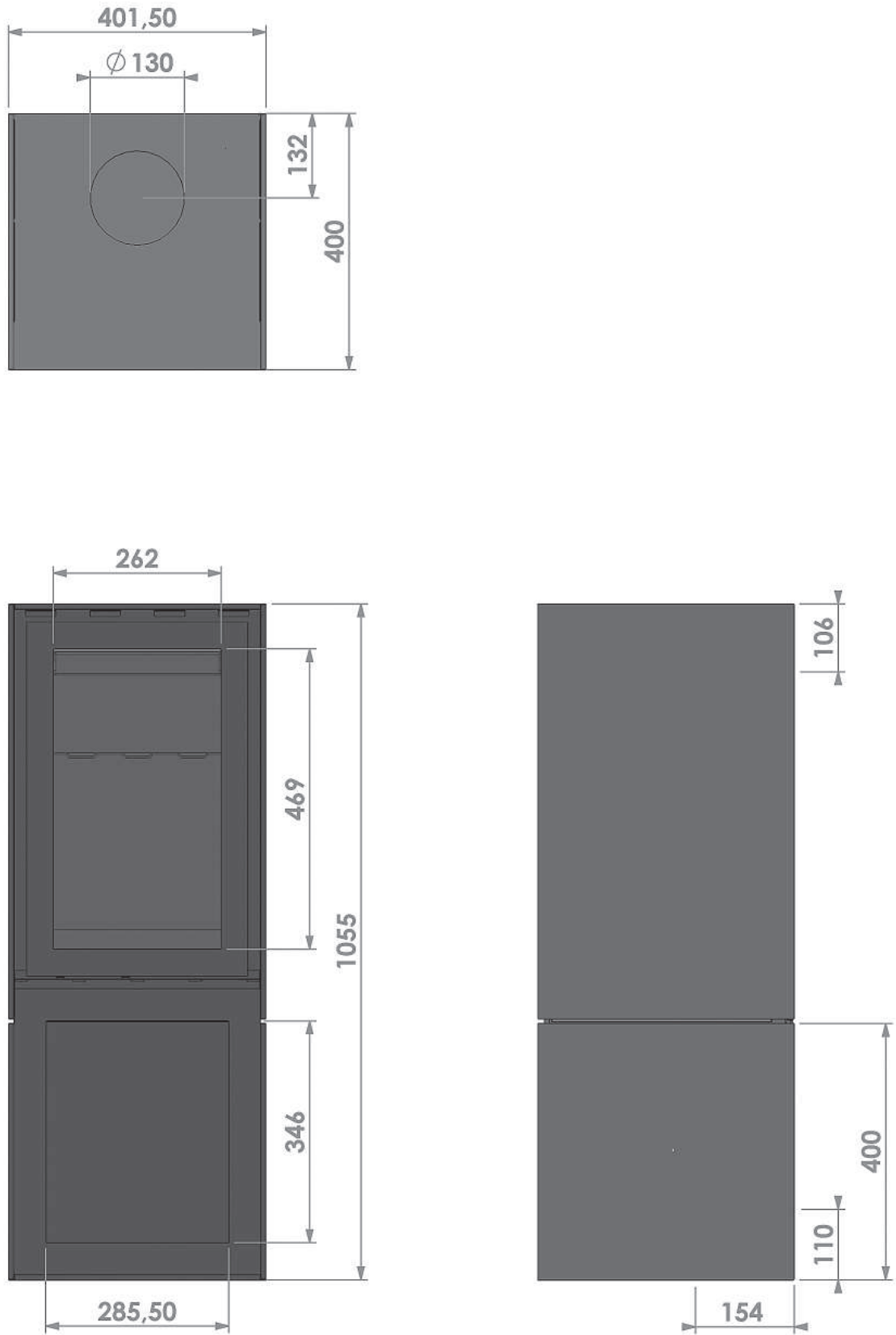

## 8 TECHNICAL DATA

### Combustion:

Measured in compliance with EN 13240 : 2001 and EN 13240 - A2 : 2004

Fuel	Wood
Nominal output	6 kW
Efficiency	76%

Emissions (dry, at 13% O<sub>2</sub>, 273 K, 1013 hPa):

Carbon monoxide (CO)	0.09%; 1171 mg/Nm <sup>3</sup>
Dust	20 mg/Nm <sup>3</sup>
Total hydrocarbons (C <sub>x</sub> H <sub>y</sub> )	104 mg/Nm <sup>3</sup>
Nitrogen oxides (NO <sub>x</sub> )	110 mg/Nm <sup>3</sup>

Flue gas mass flow	6.3 g/s
Flue temperature	302°C
Chimney draught	0.12 mbar
Flue gas connection	Ø130 mm
Weight Box	127 kg
Weight Box with wood log store module	155 kg

### Inside:

Interior side panels	Heat-resistant panels 1400 kg/m <sup>3</sup> , 1300°C
Interior bottom	Steel (heat-resistant and rust-proof)
Inner lining	Steel (heat-resistant and rust-proof)
Bottom baffle plate	Heat-resistant panel 2000 kg/m <sup>3</sup> , 1300°C
Top baffle plate	Stainless steel

### Outside:

Construction	Sheet-steel casing.
Doors	Flat door opening to left. Shutter with fixed handle.

### Operation:

- Handle for opening the door.
- Combustion air supply slider  
Single combined slide for controlling the primary, secondary and tertiary air supply.

### Ash collection:

Ashtray with grate.

### Combustion air supply:

At least 50 cm<sup>2</sup> opening in the room where the fire is located or a outside air supply opening of Ø80 mm in wall/floor.

**9 WARRANTY TERMS****Barbas Bellfires B.V.  
Warranty terms**

Barbas Bellfires B.V. guarantees the quality of the supplied Barbas appliance and the quality of the materials used. All Barbas appliances are developed and manufactured according to the highest possible quality standards. If, despite all this, something should prove amiss with the Barbas appliance you have purchased, Barbas Bellfires B.V. offers the following manufacturer's warranty.

**Article 1: Warranty**

- 1.1. If Barbas Bellfires B.V. determines that the Barbas appliance you have purchased is defective as a result of a flaw in the construction or material, Barbas Bellfires B.V. guarantees to repair or replace the appliance free of charge, without charging any costs for labour or spare parts.
- 1.2. Repair or replacement of the Barbas appliance will be undertaken by Barbas Bellfires B.V. or by a Barbas dealer as designated by Barbas Bellfires B.V.
- 1.3. This warranty is supplementary to the existing legal national warranty of Barbas dealers and Barbas Bellfires B.V. in the country of purchase and is not intended to restrict your rights and claims based on the applicable legal provisions.

**Article 2: Warranty conditions**

- 2.1. Should you wish to claim under the warranty, please contact your Barbas dealer.
- 2.2. Complaints should be reported as quickly as possible after they have manifested themselves.
- 2.3. Complaints will only be accepted if they are reported to the Barbas dealer, together with the serial number of the Barbas appliance which is stated on the front of the instructions for use.
- 2.4. In addition, the original receipt (invoice, receipt, cash receipt) showing the date of purchase must also be submitted.
- 2.5. Repairs and replacements during the warranty period do not give any entitlement to an extension of the warranty period. After a repair or replacement of warranty parts, the warranty period shall be deemed to have started on the date of purchasing the Barbas appliance.
- 2.6. If a certain part is eligible for the warranty and the original part is no longer available, Barbas Bellfires B.V. shall ensure that an alternative part of at least the same quality shall be provided.

**Article 3: Warranty exclusions**

- 3.1. The warranty on the Barbas appliance ceases to be in effect if:
  - a. it is not installed according to the supplied installation instructions, and to national and/or local regulations;
  - b. it has been installed, connected or repaired by a non-Barbas dealer;

- c. it has not be used or maintained according to the instructions for use;
  - d. it has been changed, neglected or roughly treated;
  - e. it has been damaged as a result of external causes (outside the appliance itself), for example, lightning strike, water damage or fire;
- 3.2. In addition, the warranty lapses if the original purchase receipt shows any change, deletion, removal or if it is illegible.

**Article 4: Warranty area**

- 4.1. The warranty is only valid in those countries where Barbas appliances are sold through an official dealer network.

**Article 5: Warranty period**

- 5.1. This warranty will only be granted during the warranty period.
- 5.2. The body of the Barbas appliance is guaranteed for a period of 10 years against construction and/or material faults, starting from the moment of purchase.
- 5.3. For other parts of the Barbas appliance, a similar warranty applies from the moment of purchase for a period of one year.
- 5.4. For user parts such as glass, glass (cord), thermocouple and the interior of the combustion chamber, a similar guarantee is given until after the first burning.

**Article 6: Liability**

- 6.1. A claim granted by Barbas Bellfires B.V. under this warranty does not automatically imply that Barbas Bellfires B.V. also accepts liability for any possible damage. The liability of Barbas Bellfires B.V. never extends further than that stated in these warranty conditions. Any liability of Barbas Bellfires B.V. for consequential damage is expressly excluded.
- 6.2. That stated in this provision is not valid if and to the extent that is derives from a mandatory provision.
- 6.3. All agreements entered into by Barbas Bellfires B.V. are, unless specifically stated otherwise in writing and to the extent that they are permitted based on applicable law, subject to the FME-CWM general sales and delivery conditions for the technology industry.

Barbas Bellfires B.V.  
Hallenstraat 17  
5531 AB Bladel  
The Netherlands  
Tel: +31-497339200  
Email: info@Barbas.com

Carefully retain the instructions for use; they show the serial number of the appliance. You will need this if you wish to claim under the warranty.

**barbas.** wood fires

**Your Barbas dealer**

04 - 270519 - 344186